

THE PAVILIONS

AT RANCHO MIRAGE



- A 98,500 square foot neighborhood shopping center
- Anchored by **PAVILIONS** Supermarket
- Located in the heart of the Coachella Valley in Rancho Mirage
- Only neighborhood center within 3 miles
- 1.5 miles from Eisenhower Medical Center
- 2007 Demographics

	3 mile	5 mile
Population:	32,422	100,569
Average Household Income:	\$91,350	\$77,084
- Traffic counts: 40,541 cars/day



(714) 241-0400
(800) 353-7822
Broker Co-operation
www.WestarAssociates.com

THE PAVILIONS

AT RANCHO MIRAGE

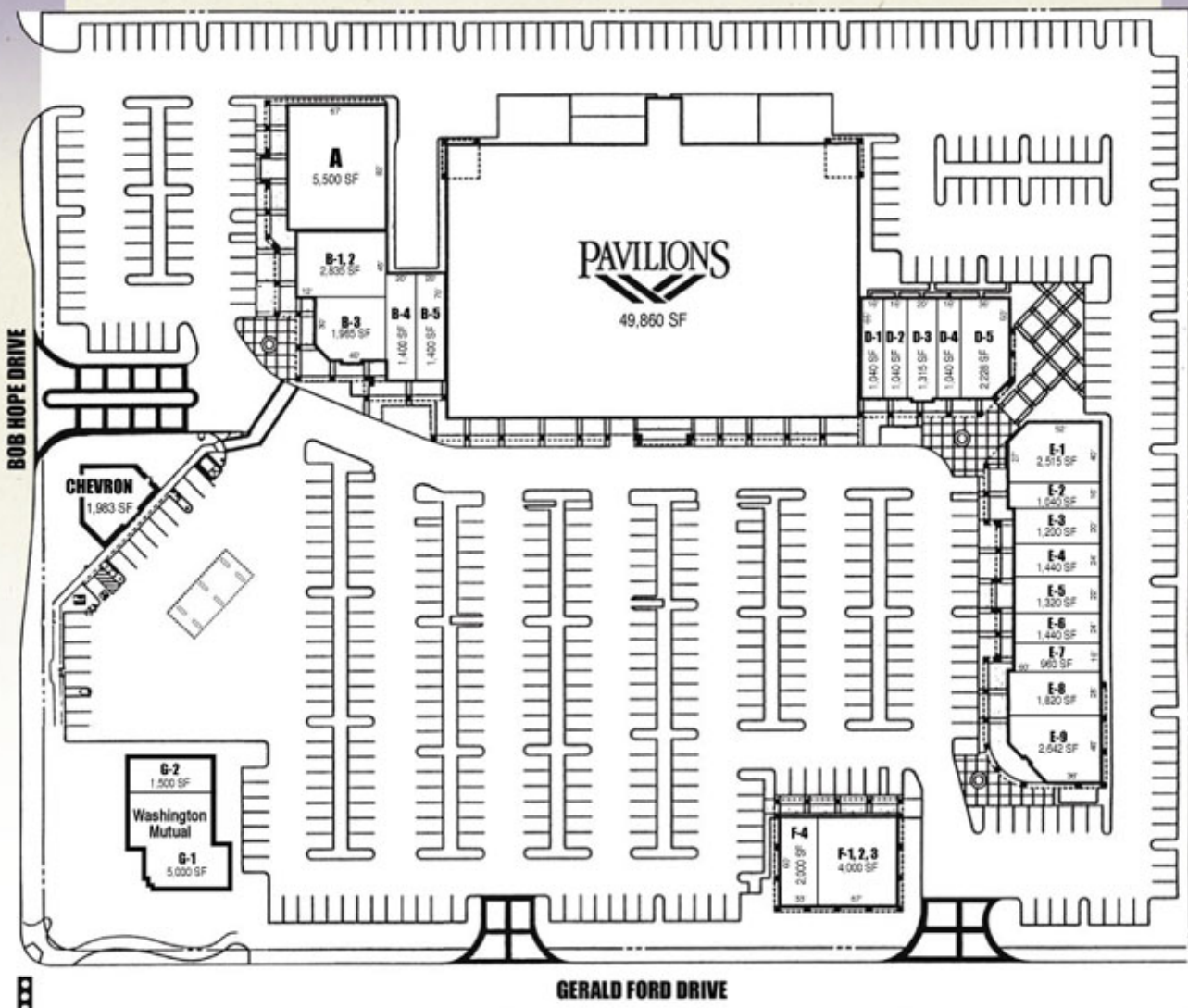

WESTAR ASSOCIATES

(800) 353-7822 • (714) 241-0400



Figures shown are based on approximate square footages. Actual square footages may change in the final development. All buildings and improvements and the uses therefore shown on this plan, are subject to modification at any time at the owner's discretion without notice.